

## FEATURES

- Economical version
- Easy installation
- Panel mounting style

## APPLICATION

- LP draft measurement
- Furnace or flew measurement
- Steam boilers, ships & thermal power stations

## REFERENCE

EN 837-1

### Edge Wise



### STANDARD PARAMETERS

Accuracy	:	CL 2.5
Ambient temperature	:	20...+65°C
Service temperature	:	65°C max.

### MATERIAL OF CONSTRUCTION

Sensing element	:	Bellows
Case & front panel	:	Steel, black painted
Bellows	:	Copper alloy
Shank	:	AISI 304 SS
Movement mechanism	:	Copper alloy
Dial	:	Aluminum, black powder coated, externally adjustable
Gaskets	:	Neoprene
Window	:	Plexi glass

### STANDARD SPECIFICATIONS

Dial size	:	150 x 78 mm / 200 x 104 mm
Range	:	-6,000...6,000 mmWC
Mounting pattern	:	Back connection with mounting bracket
Process connection	:	1/4" BSP (M)
Execution	:	Dry
Mounting bracket	:	1 Set.

### TEMPERATURE EFFECT

When temperature of the measuring system deviates from reference temperature (+20°C) max error  $\pm 0.4\%$  / 10K of true scale value.

DIMENSIONAL DRAWING

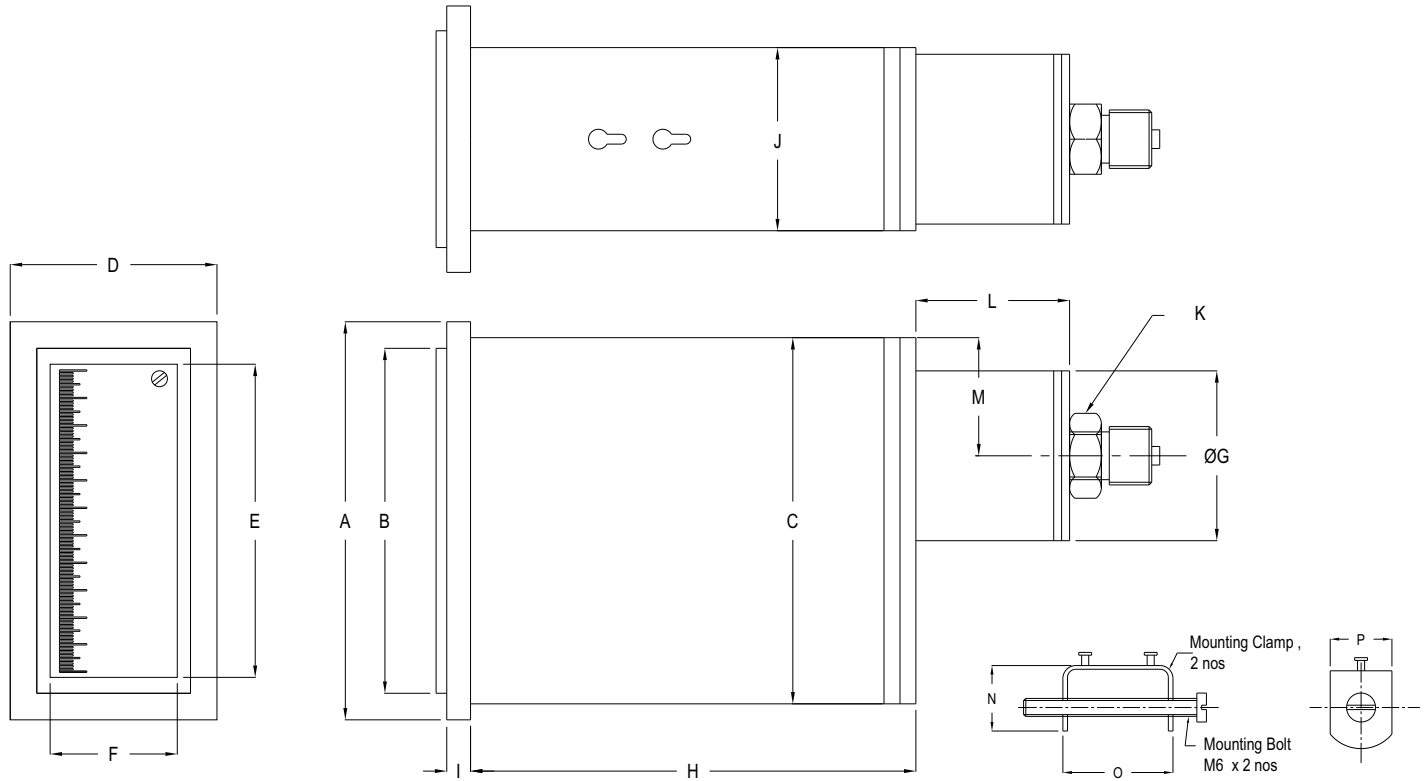

DN	A	B	C	D	E	F	ØG	H	I	J	K	L	M	N	O	P	Weight (Grams)
150 x 78	150	130	138	78	118	47	64	168	9	69	A/F 22	58	44.5	20	50	17.5	1500
200 x 104	200	180	188	78	168	47	64	168	9	69	A/F 22	58	44.5	20	50	17.5	1900

All dimensions are in mm.

ORDERING CODES

1. DIAL SIZE

- A6 150 x 78 mm
- A8 200 x 104 mm

A6

2. RANGE

- XXX Refer "Range Table"

XXX

3. MOUNTING PATTERN

- X9 Back entry with mounting bracket

X9

4. PROCESS CONNECTION

- 12N 1/4" NPT (M)
- 14N 1/2" NPT (M)
- 12B 1/4" BSP (M)
- 14B 1/2" BSP (M)

12B

5. INGRESS PROTECTION

- EV IP 54

EV

6. EXECUTION

- EA Dry

EA

7. OTHER OPTIONS

- TA 5 - point calibration certificate
- XF SS tag plate, AISI 304 SS
- XR Custom designed dial
- XT Dial tag marking

XX

Ordering Example : P804-A6-XXX-X9-12B-EV-EA

NOTES

- 1. For other connections, please contact factory.